

RUNG CAP REPLACEMENT

READ THESE INSTRUCTIONS COMPLETELY BEFORE YOU START. IF YOU DON'T UNDERSTAND THESE INSTRUCTIONS, PLEASE CALL 800-453-1192 FOR ASSISTANCE.

Procedure for replacing rung caps on Little Giant Ladder Systems **ALTA-ONE, CLASSIC, SKYSCRAPER, and SUPER DUTY** ladders.

1. Failure to comply with all instructions may result in serious injury.
2. Make sure this kit is compatible with your ladder. If you have any questions concerning the use of this kit on Little Giant Ladder Systems products, call 800-453-1192 for assistance.
3. Before installing this kit, identify all kit components. If any components are missing or damaged, please contact Customer Care. Do not substitute any components.
4. Inspect the ladder before installing this kit. Repair or replace any damaged or missing ladder parts before using the ladder. Use only Little Giant Ladder Systems repair or replacement parts. If you are unable to repair it, discard the ladder.

COMPONENTS IN KIT

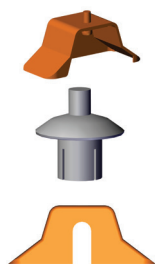

Unslotted Rung Cap

Drive Rivet (Except Alta-One kits)

Slotted Rung Cap

TOOLS NEEDED



(1) Hammer



(1) 3/16" Drill Bit



(1) 3/16" Punch



(1) Chisel



(1) Rubber Mallet



(1) Drill



(1) Pliers

NOTE: IF ANY OTHER PART OF THE LADDER IS DAMAGED BEFORE OR DURING THE PROCESS OF INSTALLING AND/OR REPAIRING, DISCARD THE LADDER OR CONTACT CUSTOMER CARE FOR INSTRUCTIONS.

DO NOT USE A DAMAGED LADDER!

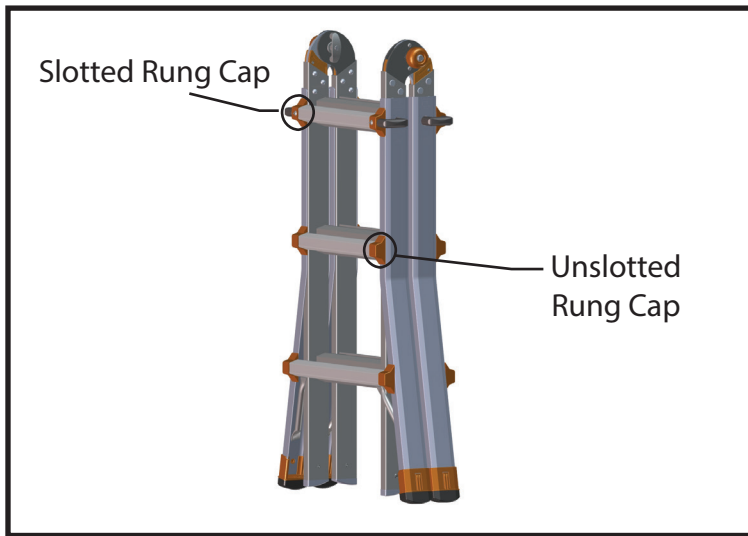

1. Identify all the rung caps.

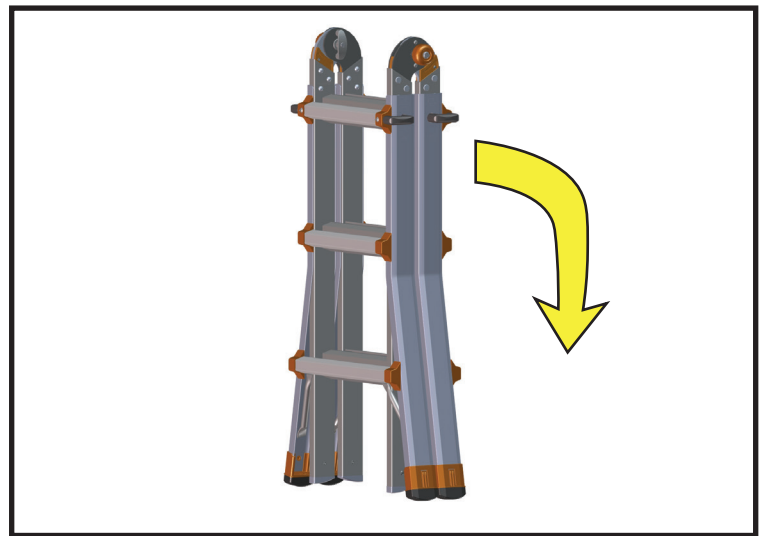

2. Lay the ladder on its back.

Slotted Rung Cap

For: Classic, Skyscraper, and Super Duty Ladders

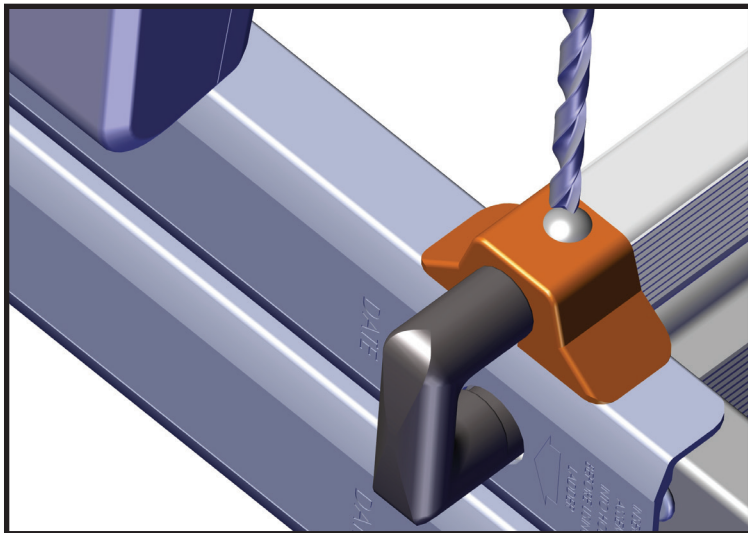

3. Use a 3/16" drill bit to drill the center of the rivet.

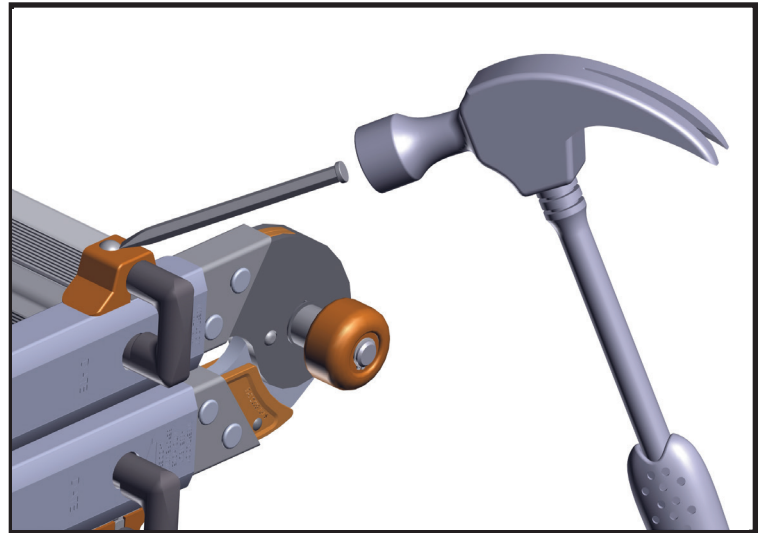

4. Using a hammer and a chisel, remove the remainder of the top of the rivet.

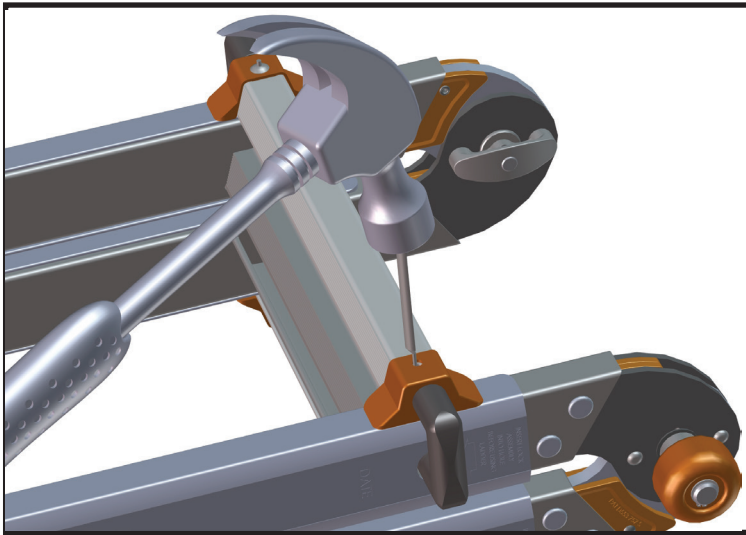

5. Using a 3/16" punch, carefully break up and remove the remainder of the rivet left in the lock.

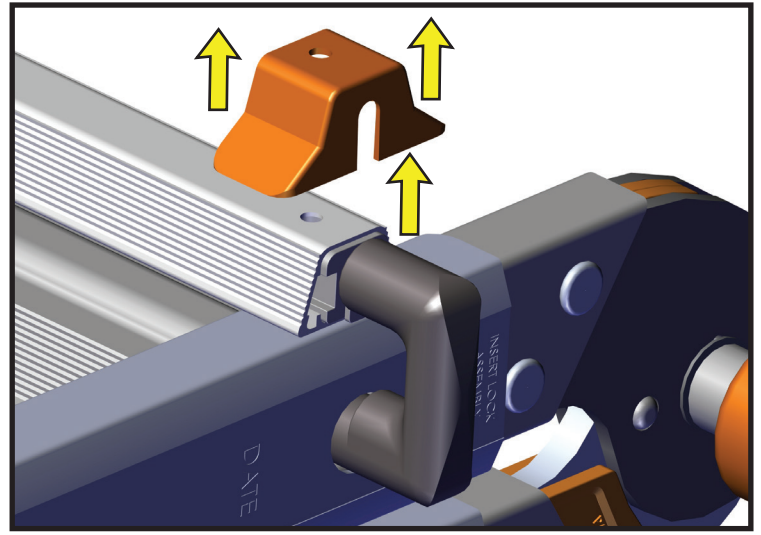

6. Remove and discard the (old) rung cap.

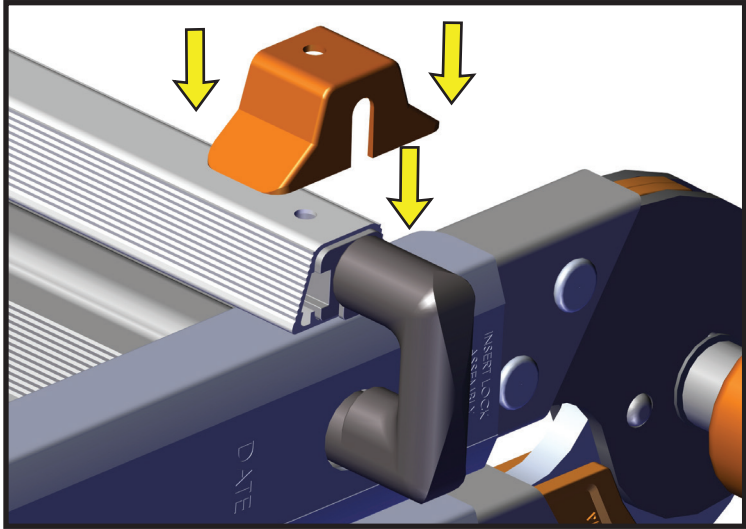

7. Insert the new rung cap, as shown.

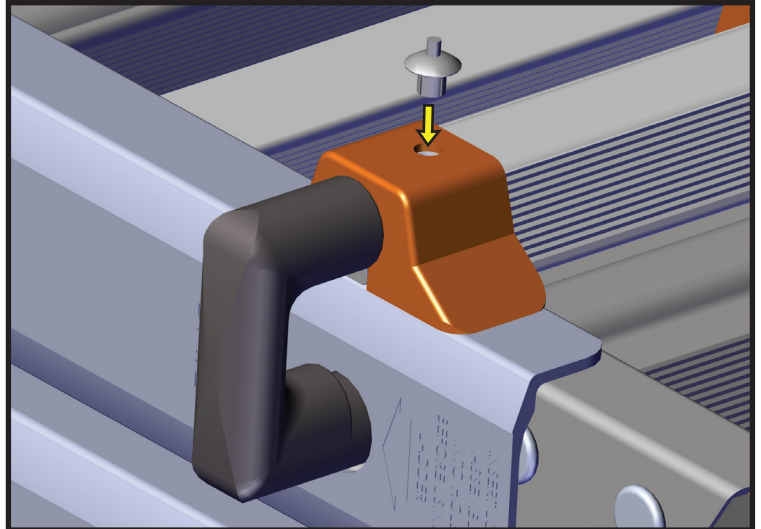

8. Insert the new drive rivet.

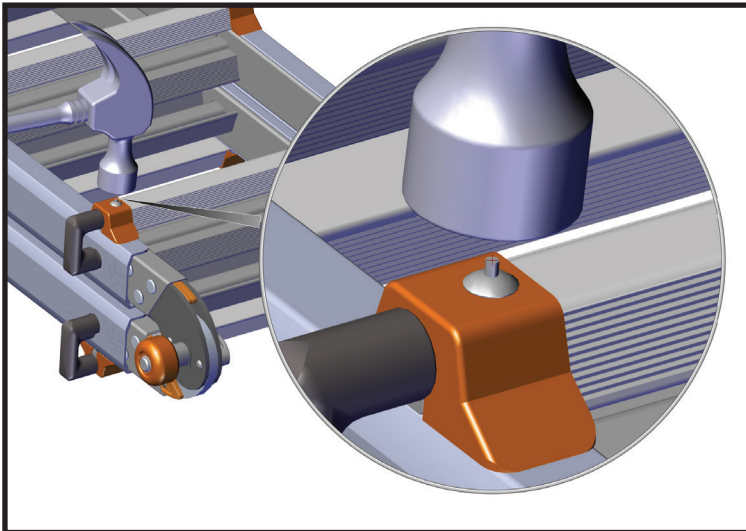

9. Secure the drive rivet with a hammer by hitting head of the rivet. The rivet must be flush to the rung cap.

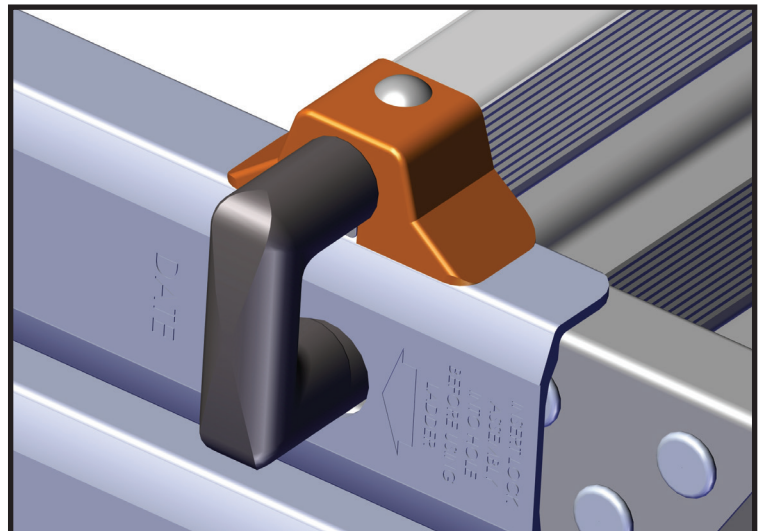

10. Once complete, replace the remaining three slotted rung caps.

Slotted Rung Cap

For: Alta-One

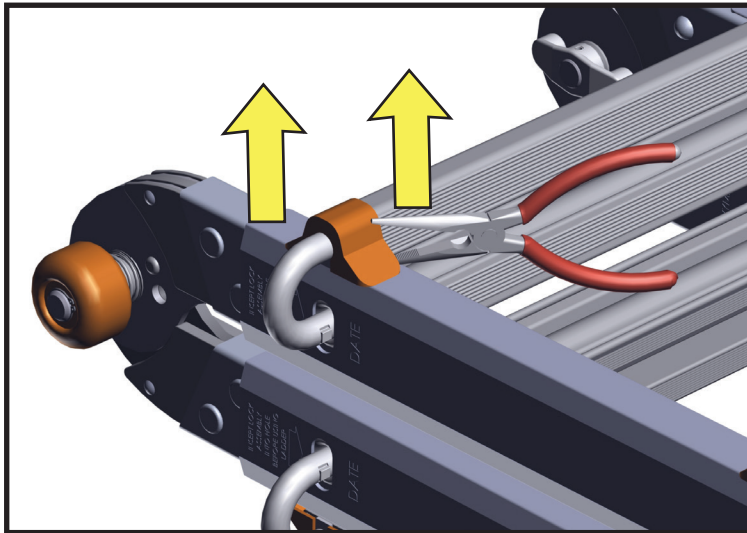

3. Using pliers remove and discard old rung cap.

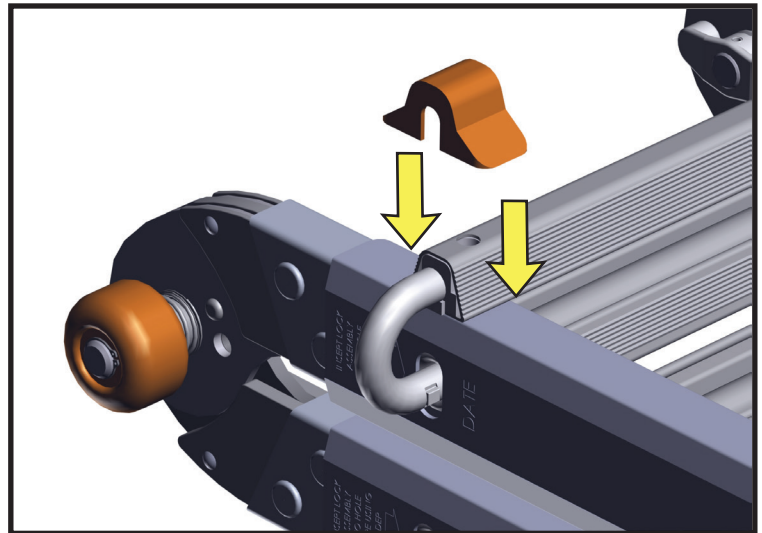

4. Place new slotted rung cap on ladder.

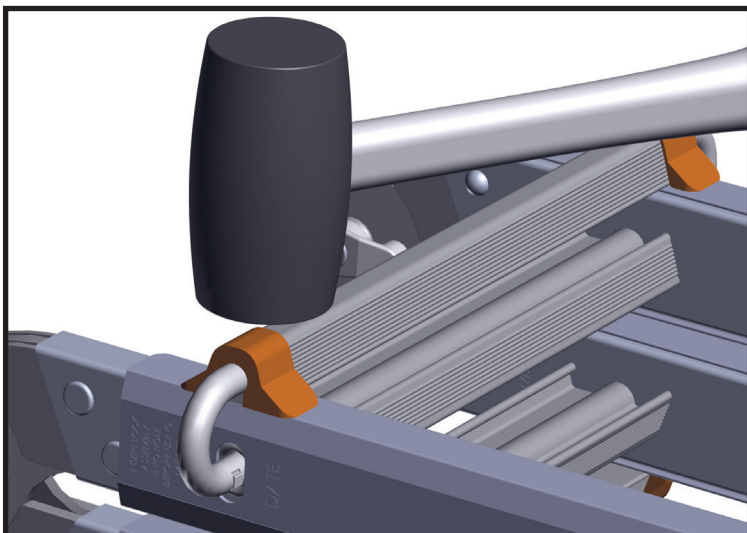

5. With a rubber mallet, strike the top of the rung cap to secure into place.

Unslotted Rung Cap

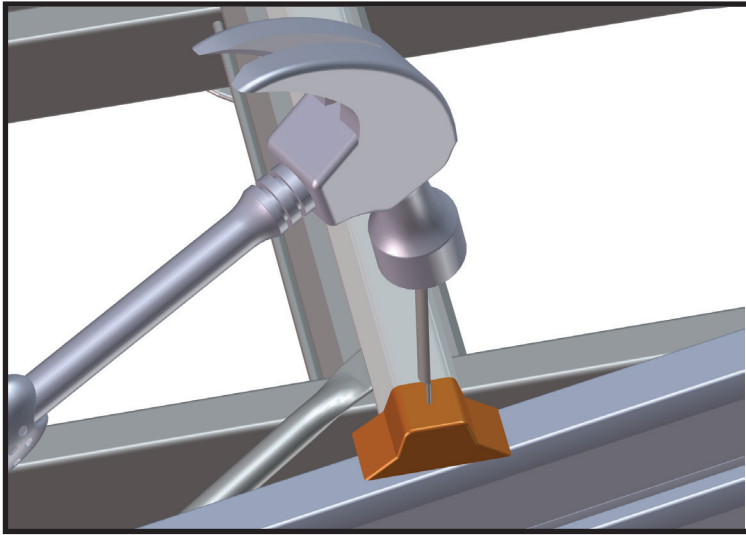

3. Using a 3/16" punch and a hammer, drive out the plastic peg holding the end cap in place.

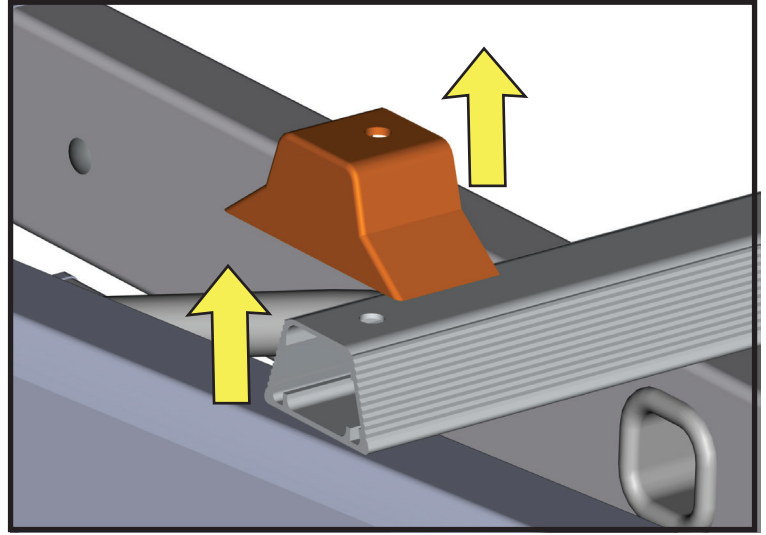

4. Remove and discard the (old) rung cap.

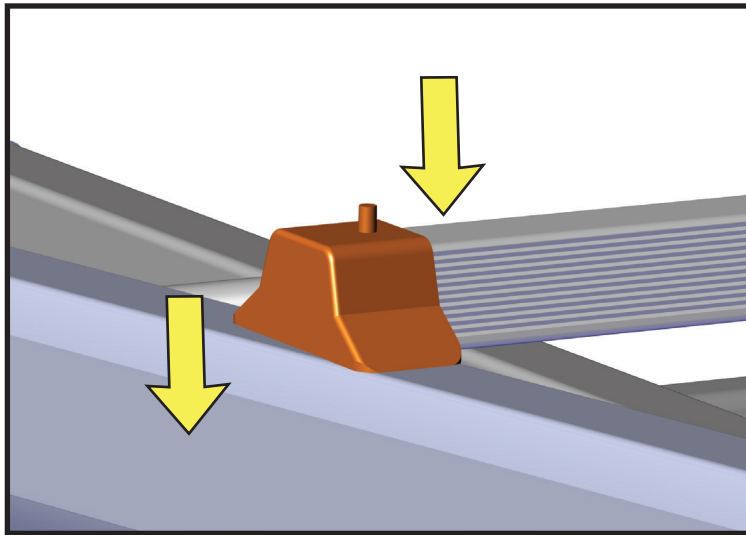

5. Put the new rung cap in place.

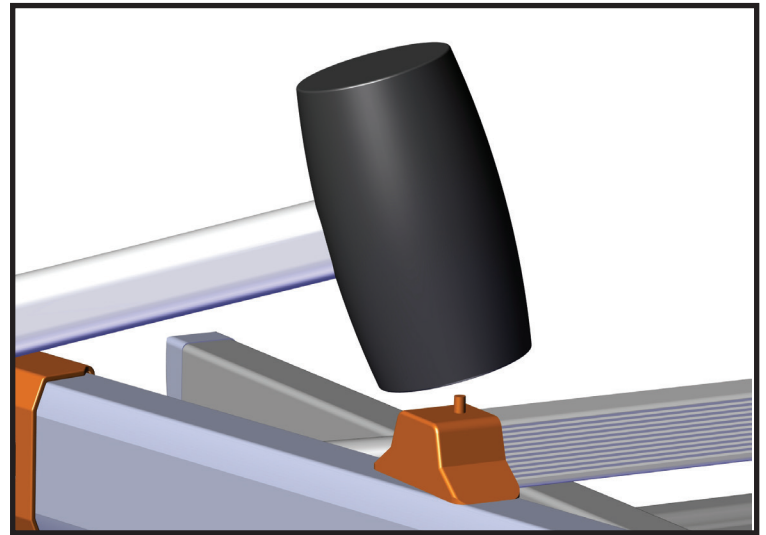

6. Secure the rung cap with a rubber mallet by firmly hitting the built in peg on top of the cap, as shown, until peg is set flush. Repeat process on all rung caps.